

One Click LCA February 2021 release notes

Software update 21 February 2021

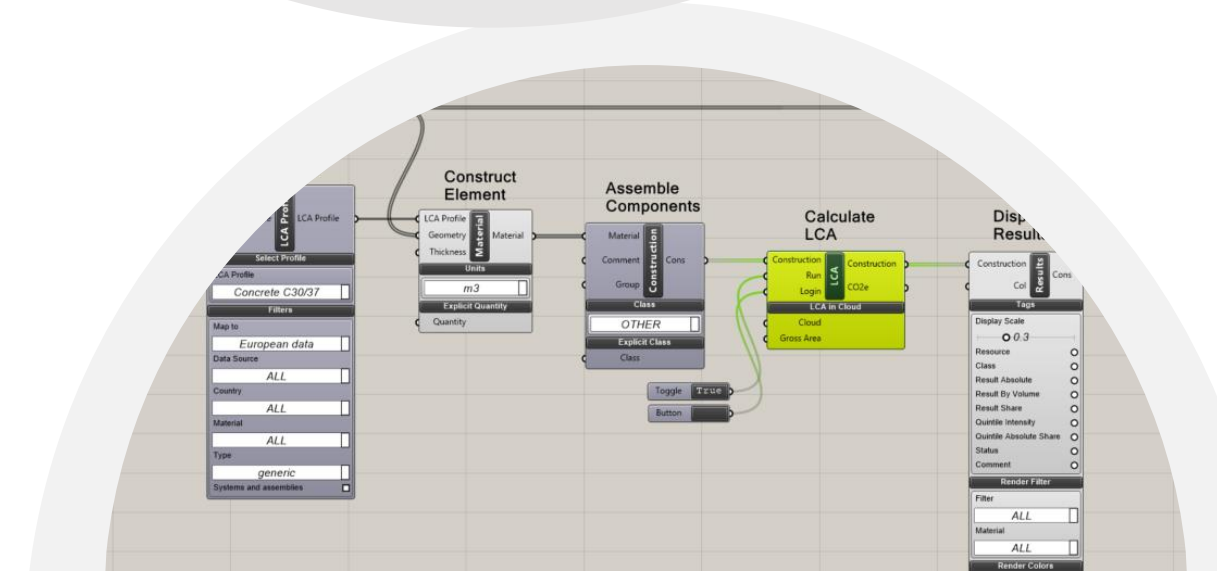

February 2021 – software update content

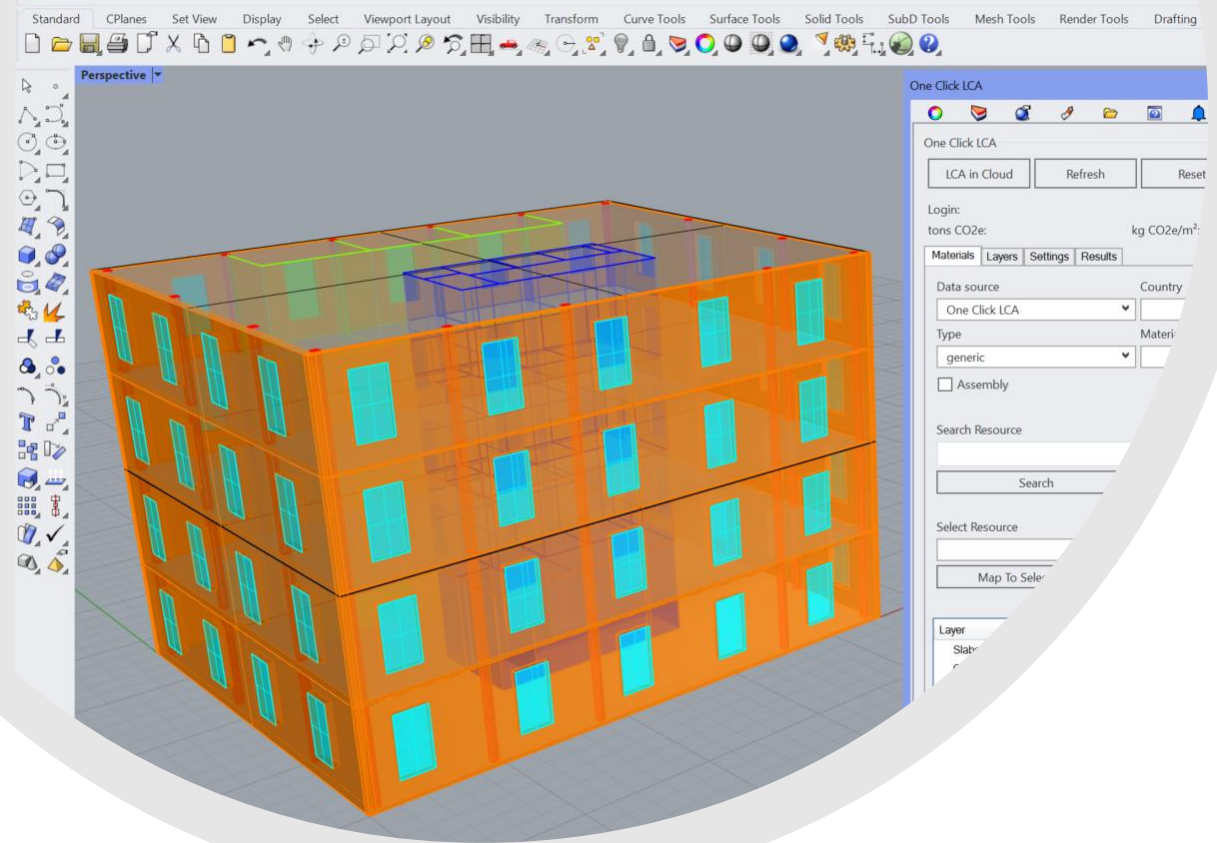

- ✓ **Rhino and Grasshopper beta plugins are now available**
- ✓ **Material database structure update with 15 new material classifications – can affect calculated impacts for 1% of the database**
- ✓ **Manufacturing localization fixes for Starter / Business users – Results will change when affected designs are resaved**
- ✓ **Chat with customer support center functionality is dropped to ensure on-time response and quality**
- ✓ **EPD tool updates**
- ✓ **French tool improvement – separate notification was sent out to users**
- ✓ **Few minor fixes and updates**

Rhino and Grasshopper plugins are now available



Plugins and guidance can be found here:

1. Rhino <https://oneclicklca.zendesk.com/hc/en-us/articles/360016862320>
2. Grasshopper <https://oneclicklca.zendesk.com/hc/en-us/articles/360019399220>

License and data limitations:

- ✓ Current versions do not support imperial units
- ✓ Business license users, can export material quantities and mappings with both plugins, but can not perform any calculations inside the plugins (same as with all integrations)



Plan Availability

STARTER

✓ BUSINESS

✓ EXPERT

CUSTOMER
REQUEST!

Database structure updates



The update includes 15 new material classifications and a range of naming and structuring updates.

Benefits:

- ✓ Users can now find more easily desired data
- ✓ Improvements in accuracy of existing green material benchmarks
- ✓ Creation of new green material benchmarks for 15 material categories
- ✓ Improvements in the default values that are generated from One Click LCA for a range of parameters and for each material group

Implications:

- ✓ 850 datapoints - so less than 2% of total database – will be reclassified
- ✓ All these data can have updated default values for a range of parameters, such as transportation distances or cost proposals
- ✓ Out of these data, up to 450 materials - so less than 1% of the database – can change impacts if the project is resaved, and if the default parameters - Manufacturing localization v1 and EoL method “Material-locked recommended” – are used. Projects using Manufacturing localization method v2 Beta will have most changes if they are resaved.

More information can be found in the customer support center: <https://oneclicklca.zendesk.com/hc/en-us/articles/360015193900>



Plan Availability

✓ STARTER

✓ BUSINESS

✓ EXPERT

CUSTOMER
REQUEST!

Manufacturing localization fixes for Starter / Business users – results change when project is resaved



Update 1:

Starter and Business license users selecting “Disable material localization” method for Manufacturing localization in project LCA parameters, will get always the method disabled also for new inputs. This method was indeed applying correctly for existing data in a project and for newly added One Click LCA generic data, but not for non-local EPDs that were added after the parameters were saved. **Calculation will be updated as soon as an affected design is resaved.**

Update 2:

Starter and Business license users can now select the electricity profile that is used for Manufacturing localization method in project LCA parameters and the impacts will be updated accordingly. For existing projects where this option had been already selected, **the calculation will be updated as soon as an affected design is resaved.**

Interface update in product level (EPD) tools



User interface update took place already on Thursday 18th February.

Relevant data in projects will still be retained.

Benefits:

- ✓ Easier for users to input data
- ✓ Reduce the need of manual editing to generate EPD documentation

As part of the change, some of the queries and sections will be different, with some obsolete fields removed and other new fields added.